

RECORD OF SURVEY

CITY OF BLACK DIAMOND SHORT PLAT NO. 12594
FOR CATHIE McLAUGHLIN IN THE NE 1/4 OF
SEC. 15, T.21N., R.6E., W.M., KING COUNTY, WASHINGTON.

APPROVALS

EXAMINED AND APPROVED THIS 5th DAY OF Dec., 1994.

CITY OF BLACK DIAMOND ADMINISTRATOR OF PLANNING/BUILDING/PUBLIC WORKS DEPT.

EXAMINED AND APPROVED THIS _____ DAY OF _____, 1994.

CITY OF BLACK DIAMOND DEVELOPMENT SERVICES DIRECTOR

EXAMINED AND APPROVED THIS 8th DAY OF MAY, 1994.

Scott Noble by De Hoffmann
KING COUNTY ASSESSOR

COMMENTS:

- 1.) GARAGE OVERHANG TO BE REMOVED
- 2.) FENCE ON UNION DRIVE TO BE REMOVED
- 3.) AREA FROM 20' RAD. ON DAIL DR. IS HEREBY DEEDED TO THE CITY OF BLACK DIAMOND

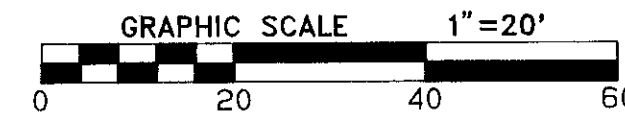

FOUND 2" HEX BOLT W/ P.M.
N54°17'23"E 8.68'

FOUND 3 1/2" BRASS CAP
ON 2" I.P., UP 0.4'

FOUND STONE MON. W/ "X",
8" DOWN, 3.14 E & 1.02 N

FOUND 1/16 COR. W/
3 1/2" BRASS CAP ON 2" I.P.

LEGAL DESCRIPTION

Commencing at the northeast corner of Section 15, Township 21 North, Range 6 East, W.M., in King County, Washington; thence S89°10'W along the north line of said Section 15, 1081.29 feet; thence S0°12'E 71.25 feet to true point of beginning; thence S0°12'E 120 feet; thence S89°48'west 160 feet; thence N0°12'W 120 feet; thence N89°48'E 160 feet, more or less, to place of beginning; (BEING KNOWN AS Lot 17, Block A, Morganville Addition, according to the unrecorded plat thereof).

ASSESSOR'S PARCEL NO. 5643600085

BASIS OF BEARING: PER DEED

LEGEND

- DECIDUOUS TREE
- LIGHT POLE
- WATER VALVE
- SEWER MANHOLE
- FIRE HYDRANT
- WATER METER
- UTILITY POLE
- UTILITY POLE GUY ANCHOR
- FENCE LINE
- FOUND MON. AS DESCRIBED
- SET 1/2" R/B & CAP, "LS 18898"

OWNER/DEVELOPER:

DAVE & CATHIE McLAUGHLIN
32010 MORGAN DR.
BLACK DIAMOND, WA 98010

ENGINEER/SURVEYOR:

JOHN E. CRAMER
CRAMER NORTHWEST INC.
6625 S. 190TH ST., STE B-106
KENT, WA 98032

ZONING: R 7200

WATER & SEWER: CITY OF BLACK DIAMOND

VICINITY MAP

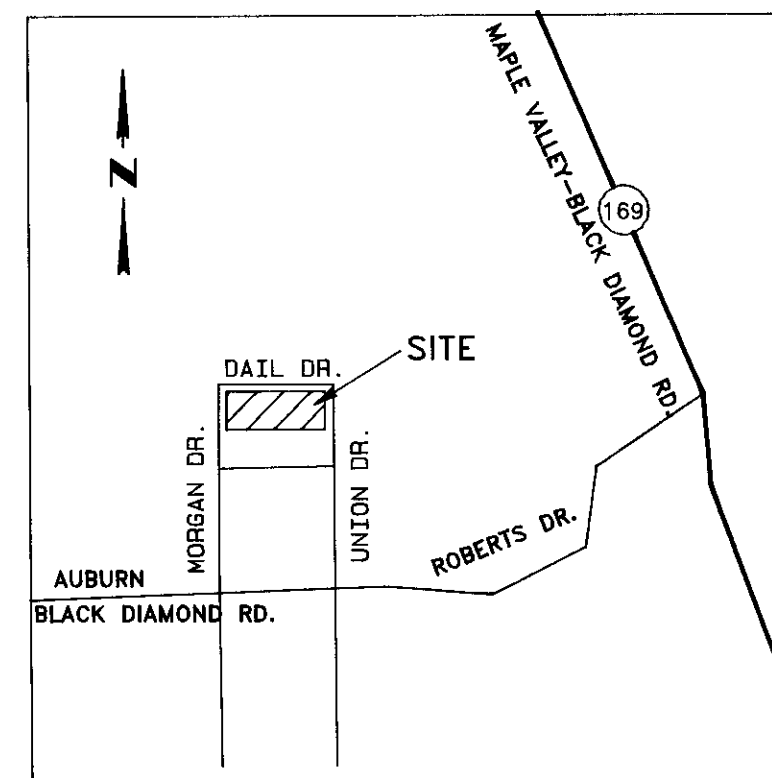

N.T.S.

FOUND 3" BRASS CAP
ON 2" I.P., UP 0.3'

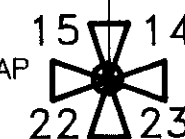

INSTRUMENT USED: NIKON TOPGUN A10LG
METHOD: TRAVERSE EXCEEDING REQUIREMENTS OF W.A.C. 332-130-090.
INDEXING DATA: NE 1/4, SEC. 15-21N-5E

RECORDER'S CERTIFICATE
FILED FOR RECORD THIS 8th DAY OF May, 1995
AT 11:55 IN VOLUME 103 OF sub
AT PAGE 171
AT THE REQUEST OF John Cramer
RECORD NO. 9505089003

SURVEYOR'S CERTIFICATE
THIS MAP CORRECTLY REPRESENTS A SURVEY MADE BY ME
OR UNDER MY DIRECTION IN CONFORMANCE WITH THE
REQUIREMENTS OF THE SURVEY RECORDING ACT AT THE
REQUEST OF CATHIE McLAUGHLIN
IN JUNE, 1994
JOHN E. CRAMER
P.L.S. NO. 18898

John E. Cramer
11/15/94
95

Cramer Northwest Inc.
Engineers Surveyors Planners
6625 S.190th St., Ste.B-106, Kent, Wa. 98032
(206) 251-0189
JOB NO.: 94047 SCALE: 1"=20' SHT.: 1 OF 2 DATE: 6/9/94

