

Title Alliance Puget Sound, LLC

33434 8th Avenue S, No 102 Federal Way, WA 98003

Phone: (253) 904-2500 | Fax: (888) 340-5685

Property Profile Report

File Number: 720-200769

Listing Agent: David Knight

Property Address: TBD XXX, Black Diamond, WA 98010

Seller/s: Cathie L McLaughlin

Date Completed: 7/19/2021

Information included:

Current Recorded Deed

Plat Map

Legal Description

Best,

Property Detail Report

WA

APN: 564360-0086

King County Data as of: 07/12/2021

Owner Information

Owner Name: McLaughlin Cathie L
Vesting:
Mailing Address: 17482 Britt Rd, Mount Vernon, WA 98273-4501
Occupancy: Unknown

Location Information

Legal Description: Morganville Unrec Lot B Of Black Diamond Short Plat #12594 Rec #9505089003 Sd Sp Daf Lot 17 Blk A Of Sd Unrec Plat Of Morganville-Less C & M Rgts Plat Block: A Plat Lot: 17
County: King, WA
APN: 564360-0086
Munic / Twnshp: Black Diamond
Subdivision: Morganville
Neighborhood: Morganville
Elementary School: Black Diamond Elem...
Latitude: 47.31461
Alternate APN: 564360008606
Twshp-Rng-Sec: 21-6-15
Tract #: 17 / A
School District: Enumclaw School District
Middle School: Thunder Mountain M...
Longitude: -122.02183
Census Tract / Block:
Legal Lot / Block:
Legal Book / Page: 902 / 187
High School: Enumclaw Sr High S...

Last Transfer / Conveyance - Current Owner

Transfer / Rec Date: Price:
Buyer Name: Seller Name: Transfer Doc #: Deed Type:

Last Market Sale

Sale / Rec Date: Sale Price / Type: Deed Type:
Multi / Split Sale: Price / Sq. Ft.: New Construction:
1st Mtg Amt / Type: 1st Mtg Rate / Type: 1st Mtg Doc #: N/A
2nd Mtg Amt / Type: 2nd Mtg Rate / Type: Sale Doc #: N/A
Seller Name:
Lender: Title Company:

Prior Sale Information

Sale / Rec Date: Sale Price / Type: Prior Deed Type:
1st Mtg Amt / Type: 1st Mtg Rate / Type: Prior Sale Doc #: N/A
Prior Lender:

Property Characteristics

Gross Living Area: Total Rooms: 0
Living Area: Bedrooms:
Total Adj. Area: Baths (F / H):
Above Grade: Pool:
Basement Area: Fireplace:
Style: Cooling:
Foundation: Heating:
Quality: Exterior Wall:
Condition: Construction Type:
Year Built / Eff:
Stories:
Parking Type:
Garage #:
Garage Area:
Porch Type:
Patio Type:
Roof Type:
Roof Material:

Site Information

Land Use: Vacant -Residential Land
State Use:
County Use: 300 - Vacant(Single-Family)
Site Influence:
Flood Zone Code:
Community Name:
Lot Area: 10,387 Sq. Ft.
Lot Width / Depth:
Usable Lot: 10387
Acres: 0.238
Flood Map #:
Flood Panel #:
Zoning: R6
of Buildings:
Res / Comm Units:
Water / Sewer Type: Public /
Flood Map Date:
Inside SFHA: Unknown

Tax Information

Assessed Year: 2020
Tax Year: 2021
Tax Area: 0905
Property Tax: \$1,428.86
Exemption:
Assessed Value: \$116,000
Land Value: \$112,000
Improvement Value: \$4,000
Improved %: 3.45%
Delinquent Year:
Market Total Value: \$116,000
Market Land Value: \$112,000
Market Imprv Value: \$4,000
Market Imprv %: 3.45%

Disclaimer: This report is not an insured product or service or a representation of the condition of title to real property. It is not an abstract, legal opinion, opinion of title, title insurance, commitment or preliminary report, or any form of title insurance or guaranty. Estimated property values are: (i) based on available data; (ii) are not guaranteed or warranted; (iii) do not constitute an appraisal; and (iv) should not be relied upon in lieu of an appraisal. This report is issued exclusively for the benefit of the applicant therefor, and may not be used or relied upon by any other person. This report may not be reproduced in any manner without the issuing party's prior written consent. The issuing party does not represent or warrant that the information herein is complete or free from error, and the information herein is provided without any warranties of any kind, as-is, and with all faults. As a material part of the consideration given in exchange for the issuance of this report, recipient agrees that the issuing party's sole liability for any loss or damage caused by an error or omission due to inaccurate information or negligence in preparing this report shall be limited to the fee charged for the report. Recipient accepts this report with this limitation and agrees that the issuing party would not have issued this report but for the limitation of liability described above. The issuing party makes no representation or warranty as to the legality or propriety of recipient's use of the information herein.

School information is copyrighted and provided by GreatSchools.org.

- Control
- RightOfWay
- Plat
- ShortPlat
- OriginalShortPlat
- Parcel
- Lot
- Easement
- Survey
- GovernmentLot
- Hydro
- DonationLandClaim
- Proposed

Parcel
Platted Major Number
City

The information on this map has been compiled by King County staff from a variety of sources and is subject to change without notice. King County makes no representations or warranties, express or implied, as to accuracy, completeness, timeliness, or rights to the use of such information. King County shall not be liable for any general, special, indirect, incidental, or consequential damages including, but not limited to, lost revenues or lost profits resulting from the use or misuse of the information contained on this map. Any sale of this map or information on this map is prohibited except by written permission of King County. This map is for assessment purposes only. It is provided to assist in locating your property and is not guaranteed to show accurate measurements or to reflect stability or suitability of tax parcels. Do not use for survey purposes.

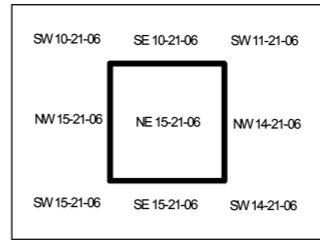

NE 15-21-06

1 inch = 100 feet
Date: 7/22/2019



(LOT 2) Lot 2 overlap with prior surveys resulted from re survey of PLSS corner NW 14-21-06 & SW 14-21-06 Ref. 9605170592
NE 15-21-06
BD BLA PLN16-0060 20170517900001
SE 15-21-06

BD LARGE LOT 5

LOT 2

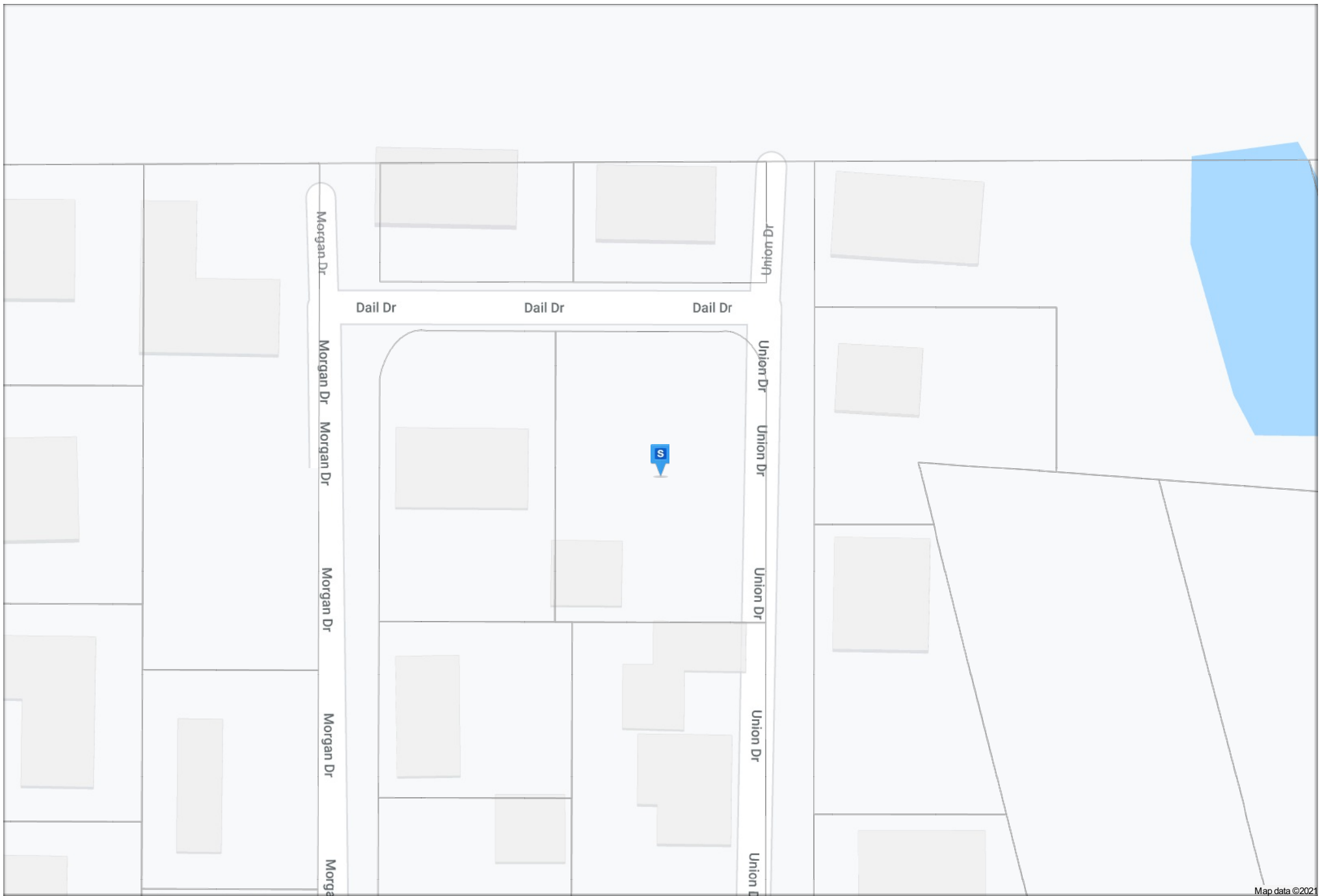

Title Alliance Puget Sound, LLC

33434 8th Avenue S, No 102 Federal Way, WA 98003

Phone: (253) 904-2500 | Fax: (888) 340-5685

EXHIBIT A

MORGANVILLE UNREC LOT B OF BLACK DIAMOND SHORT PLAT #12594 REC #9505089003 SD SP
DAF LOT 17 BLK A OF SD UNREC PLAT OF MORGANVILLE-LESS C & M RGTS PLAT BLOCK: A PLAT
LOT: 17

Parcel ID: 5643600086